

Marsh Float & Thermostatic Traps and Parts



SERIES 12/512



SERIES 8/508



SERIES 17



SERIES 14/514

Marsh's Float & Thermostatic Traps are designed to provide efficient removal of air and condensate from steam heat exchange systems. Functional and rugged, Marsh F & T Traps are used for universal applications.

Usages:

- High and low pressure systems
- Removal of air and condensate
- Steam exchange systems
- Design allows for straight-through or angled piping
- Temperatures to 250°F

Features:

- Ease of maintenance by removing top and bottom plug for cleaning
- Excellent flow-through design
- Stainless steel float
- Stainless seat and needle on high pressure models

Dimension Guide

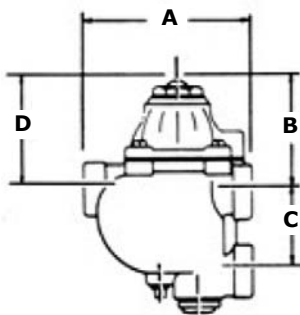

No. 12

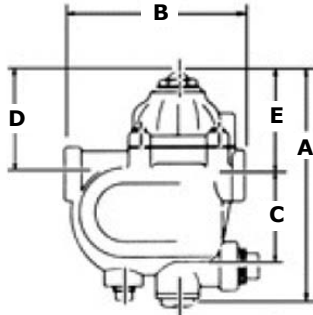

No. 8

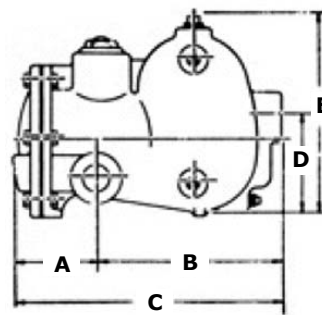

No. 14

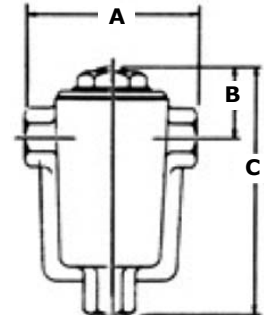

No. 17

Complete F&T Traps				Related Repair Parts						Dimensions				
Trap Model No.	Pipe Size	Max. Press. lbs/psi	ORDER NO.	Cover & Thermostat	Thermostat Seat	Internal Mechanism	Float	Cover Gasket	Bottom Plug & Gasket	A	B	C	D	
17	3/4"	15	MD1010	ME1025	ME1125	ME1090	ME1045	Not Needed	—	5	2	6 1/2	—	
12	3/4"		MD1005	ME1005	ME1115	ME1085	ME1040	ME1065	ME1110	6 1/4	4 1/8	3	4	
12	1"		MD1015	ME1005	ME1115	ME1085	ME1040	ME1065	ME1110					
8	1 1/4"		MD1020	ME1005	ME1115	ME1095	ME1050	ME1070	ME1105	10 1/2	8	4 1/4	4 1/2	
8	1 1/2"		MD1025	ME1005	ME1115	ME1095	ME1050	ME1070	ME1105	10 7/8	8 1/8	4 1/8	4 3/4	
14	1 1/2"		MD1030	ME1030	ME1140	ME1097	ME1055	ME1075	—	—	4 3/4	11	15 3/4	6 1/8
14	2"		MD1035	ME1035	ME1145	ME1100	ME1060	ME1080	—	—	4 7/8	13 5/8	18 1/2	6 1/4